

Warmer & Packaging Station **Model FAST Unit**



The Food Assembly Station (FAST unit) serves as a warming unit to hold freshly prepared product, as an assembly station to assemble and package food for customers and as a storage area for packaging and supplies.

The warming unit comes standard with three (20-3/4" L X 12-3/4" W X 4" D) pans, but you can customize this configuration using different sized pans to best suit your individual needs. The pan well is thermostatically heated and the top section uses heat lamps for additional heating and for greater visibility. The dual heating sources allow you to precisely maintain the proper temperature of your products, so your customers will get fresh, hot food every time.

The FAST unit is designed to expedite food prep and assembly and provides you with everything you need to assemble and package products quickly and easily. Easy access from both sides allows for maximum efficiency during peak service hours. The assembly area is equipped with two 10" x 45" Teflon cutting surfaces for that can easily be removed for cleaning. And, the storage area is designed to house all of the packaging and supplies required to package your products for delivery to customers.

Design Features

- Two serving sides allow for maximum efficiency during peak serving hours.
- Hinged lexan door on each side allows for easy access and visibility of the cooked product.
- Thermostatically controlled product well allows the product to stay fresh and hot at all times.
- Adjustable heat lamps help provide heat and greater visibility for products.
- Teflon cutting surfaces allow for product assembly and are removable for ease of cleaning.
- Adjustable shelves and dividers allow you to customize the storage area to fit your specific needs.

Listings



Giles Foodservice Equipment

An ISO 9001 Registered Company

2750 Gunter Park Drive West • Montgomery, AL 36109 USA

334.272.1457 • Fax 334.272.3561 • Phone Toll Free 1.800.554.4537

Web Site: www.gilesent.com • Email: info@gilesent.com

Warmer & Packaging Station

Model FAST Unit

Item No.: _____
 Quantity: _____
 Project Name: _____
 SIS#: _____
 AIA/CSI#: _____

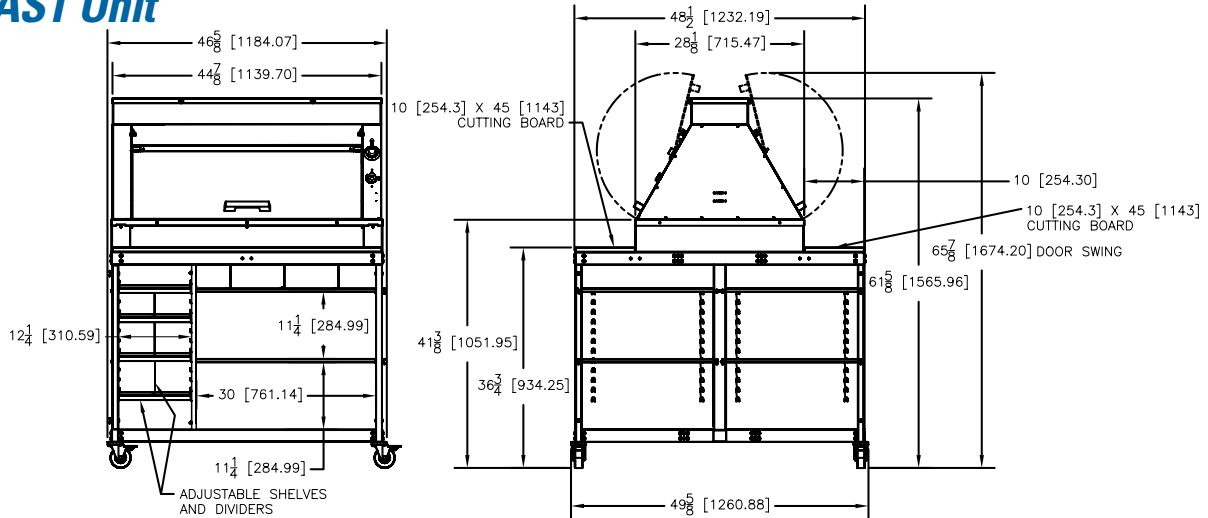

Inches [millimeters]

Front

Side

39516-A

Specifications

We reserve the right to change specifications and product design without notice. Such revisions do not entitle the buyer to corresponding changes, improvements additions or replacements on previously purchased equipment.

Construction:

Cabinet and Shelves: 20Ga to 16Ga Stainless Steel
 Doors: Lexan
 Heating Element Type: Strip Heater

Dimensions:

Width: 46-5/8" [1184.02 mm]
 Depth: 49-5/8" [1260.88 mm]
 Height: 61-5/8" [1565.96 mm]
 Teflon Cutting Board: (2) 10" X 45" [254.3 mm X 1143 mm]

Holding Temperature:

Maintains Freshly Cooked Product at 170° [76.6°C] in maximum of 2 hour intervals

Maximum Pan Capacity:

(3) Pans -20-3/4" L X 12-3/4" W X 4"D

Listings:

UL (US and Canada), UL Sanitation

Electrical Specifications:

Available voltages: 208/240 2950 WATTS
 1 phase - 208/240V - 15.5 AMPS
 Supplied with 72" [1828.8 mm] service cord and plug (NEMA plug type: L14-30)

Shipping Specifications:

Top Warming Unit-
 Crated Weight: 252 lbs [114 kg]
 Crated Cube Size: 39-1/2" X 55-1/2" X 36-3/4" = 46.6 cu ft
 [1003mm X 1410mm X 933mm = 1.3 cu meters]
 Packaging Table-
 Crated Weight: 312 lbs [142 kg]
 Crated Cube Size: 49" X 52" X 39" = 57.5 cu ft
 [1245mm X 1321mm X 991mm = 1.6 cu meters]

Accessories Included

Unit is shipped with (3) 20-3/4" L X 12-3/4" W X 4" D Pans, (2) 10" X 45" Teflon Cutting Boards, (8) Adjustable Shelves (4) per side, (12) Shelf Dividers, (5) 150W Safety Coated Heat Lamps.

How To Specify

- Electrical**
Specify the part number from the following:

	Voltage	Hz	Phase	Load Configuration	Part Number
<input type="checkbox"/>	208 or 240	60	1	Delta	70995

- Accessories***
Specify the part number and quantity of the following accessory items needed:

	Qty	Description	Part Number
<input type="checkbox"/>		Pan -20-3/4L X 12-3/4W X 4D	76184
<input type="checkbox"/>		Pan -12-3/4L X 10-3/8W X 4D	76186
<input type="checkbox"/>		Pan -12-3/4L X 6-7/8W X 4D	76189
<input type="checkbox"/>		Pan -10-3/8L X 6-3/8W X 4D	76192
<input type="checkbox"/>		Heat Lamp, 150W, Safety Coated	25356
<input type="checkbox"/>		Drawer Warmer (Single Drawer)	70993

*Additional charges

- Shipping**
Specify the shipping method

Giles Foodservice Equipment

2750 Gunter Park Drive West • Montgomery, AL 36109 USA
 334.272.1457 • Fax 334.272.3561 • Phone Toll Free 1.800.554.4537
 Web Site: www.gilesent.com • Email: info@gilesent.com